

# SD-02 Series:

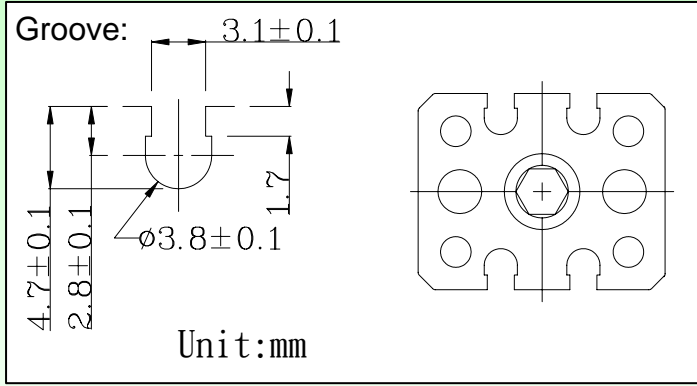

## Specification

Type	SD - 02R	SD - 02N	SD - 02P	SD - 02RN	SD - 02RP	SD - 02D
Characteristics						
Wiring	2Wire	3 Wire			2 Wire	
Connect Diagram						
Switching logic	Normally open	Solid state output, Normally open		Normally open		Solid state output
Output	Reed switch	NPN Sinking	PNP Sourcing	Reed switch		---
Lead wire type	Horizontal					
Load voltage	5 ~ 120V DC/AC	4.5~28V DC			10~28V DC	
Load current	50mA Max.	50mA Max.			2.5~40mA	
Current consumption	---	10mA Max. @ 24V		5mA @ 24V		---
Voltage drop	2.5V Max.	0.5V Max. @ 50mA (Resistive load)		0.1V Max.		3.5V Max.
Leakage current	---	50 μA Max.		---		0.8mA Max.
Frequency	500Hz	1000Hz		500Hz		1000Hz
Shock	30G	50G		30G		50G
Vibration	90 m/s <sup>2</sup> (9G), Double amplitude 1.5 mm					
Insulation resistant	DC 500V 100MΩ (Lead wire to case)					
Withstand voltage	AC 1000V (50/60Hz) 1minute (Lead wire to case)					
CE & Protection IP	EN60947-5-2		IEC529	IP67(NEMA 6)		
Indicator	Red LED					
Cable	2.6 φ, 2C, Gray Pur	2.6 φ, 3C, Black Pur			2.6 φ, 2C, Gray Pur	
Temperature range	-10 ~ 70°C					
Protection circuit	---	Reverse polarity; Surge suppression		---		Reverse; Surge
Dimensions	Reed Switch: 			Solid N/P/D: 		

