



FLOW SIGHT

GF-100



GF-100

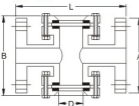

GF-200



GF-300



GF-200

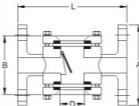

GS-100



GS-200



GS-300



GS-300

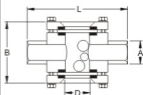

TEMPERATURE: MAX 250°C
 PRESSURE: MAX 30kg/cm²
 MATERIAL: a. Body: CS 304SS 316SS 316L SS
 P.V.C P.V.D.F P.P
 b. Packing: Asbestos, Teflon
 c. Glass: Circular Sight Glass
 CONNECTION: $\frac{3}{8}$ " ~ 4" PT or NPT
 $\frac{3}{8}$ " ~ 8" Flange Ansi. Jis. Din.

DIMENSIONS		GA, GG, GS										m/m		
MODEL		10	15	20	25	32	40	50	65	80	100	125	150	200
L		160	160	180	180	180	180	220	270	270	320	380	420	490
D		35	35	35	40	45	55	70	85	95	130	155	200	230
A*		90	95	100	125	135	140	155	175	185	210	250	280	330
B		90	90	90	100	160	170	190	210	230	250	280	320	340
F		$\frac{3}{8}$	$\frac{1}{2}$	$\frac{3}{4}$	1	1 $\frac{1}{4}$	1 $\frac{1}{2}$	2	2 $\frac{1}{2}$	3	4	5	6	8

歡迎訂製各式視流器，敬請惠予告知下列之條件：

1. 型式 (Model) 2. 液體名稱 (Name of liquid) 3. 材質 (Material) 4. 接續方式 (Connection)
 5. 操作壓力 (Oper Pressure) 6. 操作溫度 (Opere temp)

SYNTEX TECH CORP.

NO.503, SEC.2, JINLING RD., PINGJHEN CITY, TAoyUAN COUNTY 324, TAIWAN, (R.O.C)

TEL: 886-3-4679659 FAX: 886-3-4679649

www.syntextech.com.tw syntex.tech@msa.hinet.net